

Premium Booth 3mW x 3mD Right side Corner Booth

SD-A-9-R Cnr
3mW x 3mD x 3.5mH

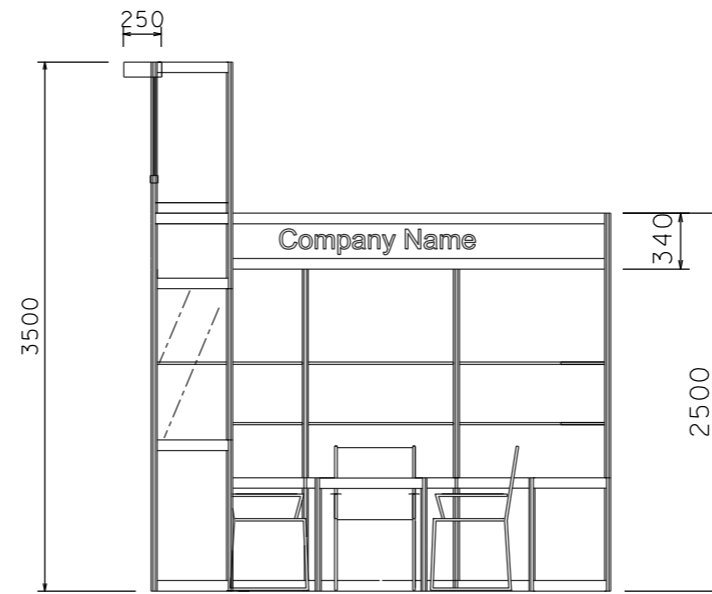
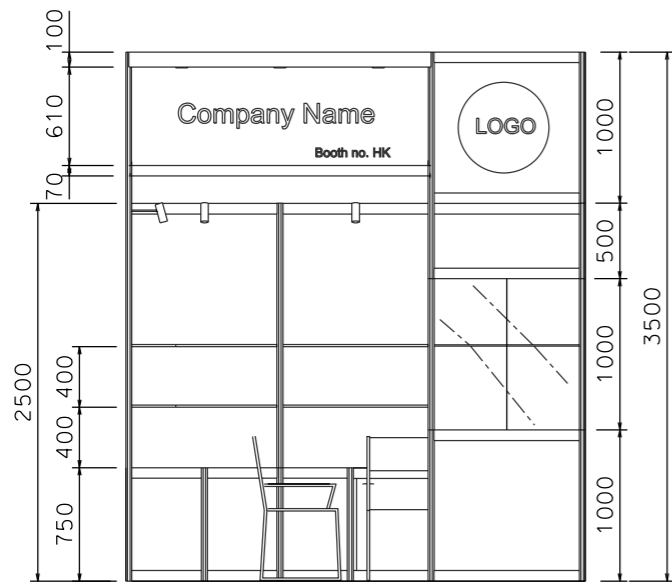
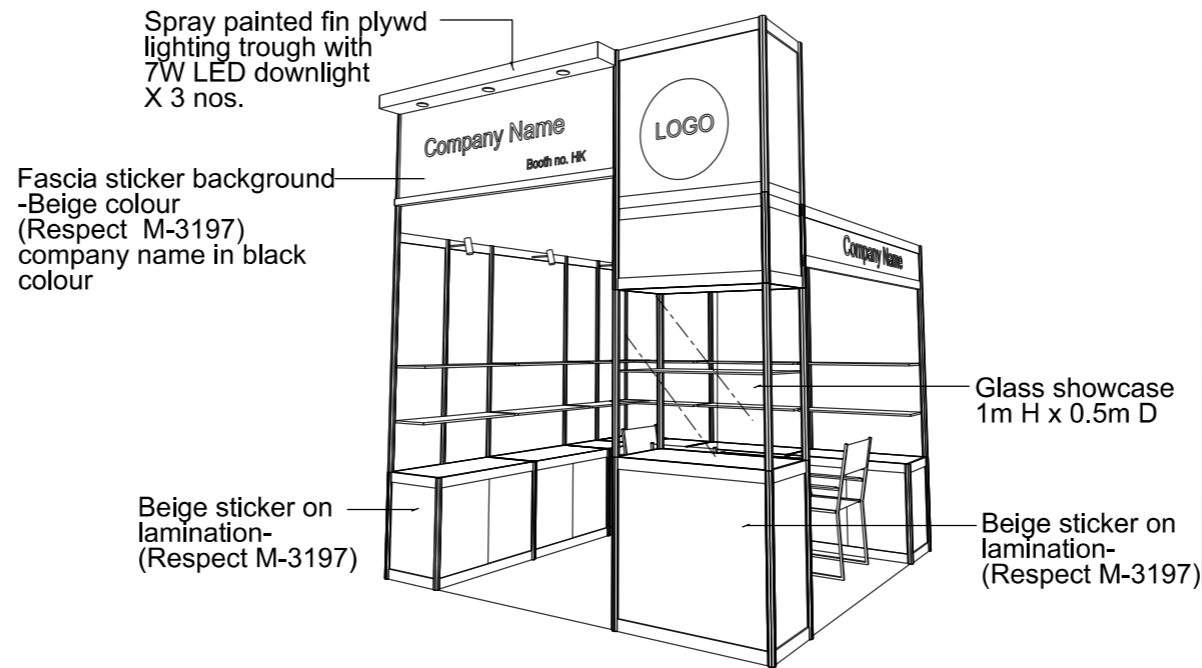
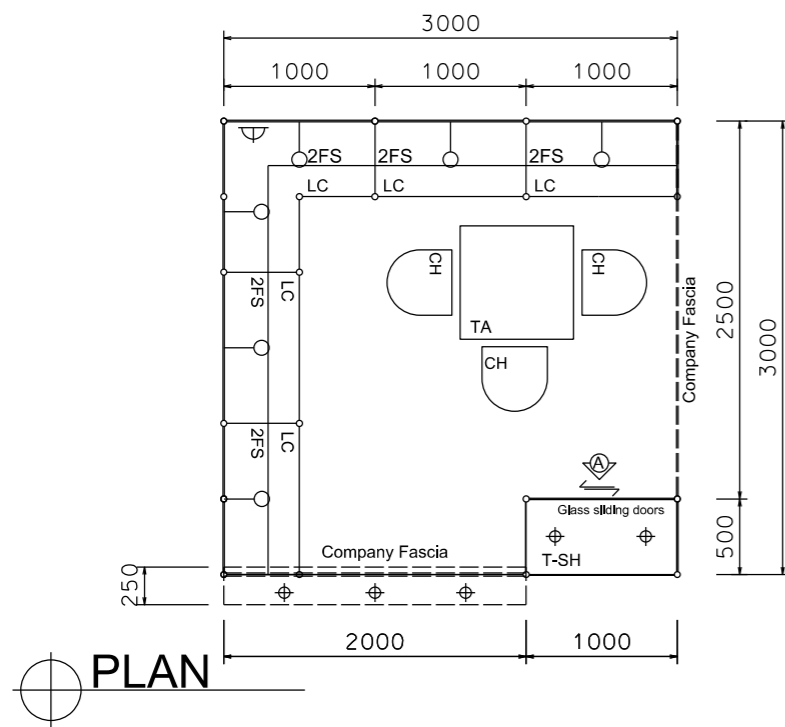

BOOTH SPECIFICATION		QTY
	Tall showcase in beige sticker lamination, 1 layer of glass shelf, 2x 7W LED downlights	1
	Lockable cabinet in beige sticker lamination (1mL x 0.5mD x 0.75mH)	5.5
	Wooden shelf (flat) (1mL x 0.3mD)	12
	Square meeting table (0.7m X0.7m x 0.75mH)	1
	Black leather chair	3
	13W LED Lamp Longarmed Spotlight (yellow)	6
	7W LED light (for fascia)	3
	500w Square pin power socket	1
	Company Logo	1

FILE PATH - L:\Local Fair Premium Booth 2011\SD-Layouts\SD-A layout\SD-A-Layout-New.dgn



NOTES UNLESS OTHERWISE SPECIFIED ALL DIMENSIONS ARE IN MM.

.....
.....
.....

REVISION
26-11-08
31-12-2008
15-01-2009
09-02-2009
18-05-2009
15-07-2009
21-01-2010
05-05-2015
08-01-2019

DATE: 08-01-2019
SCALE: 1 : 50 (A3)
DRAWN BY: ..
CHECKED BY:

TITLE
Premium Booth
SD-A-9-R
Corner

PROJECT
PREMIUM BOOTH
3m x 3m Corner
DATE: XXXXXXXX

SHEET
SD-A01b